



**knothe • bruce**  
**ARCHITECTS**  
 Phone: 8401 Greenway Blvd., Suite 900  
 608.836.3690 Middleton, WI 53562

ISSUED  
 Issued for xyz - Month Day, Year

PROJECT TITLE  
**Pacific**

Tiffin, Iowa  
 SHEET TITLE  
**Basement Floor Plan**

SHEET NUMBER

**A100**

PROJECT NO. **2521**  
 © Knothe & Bruce Architects, LLC

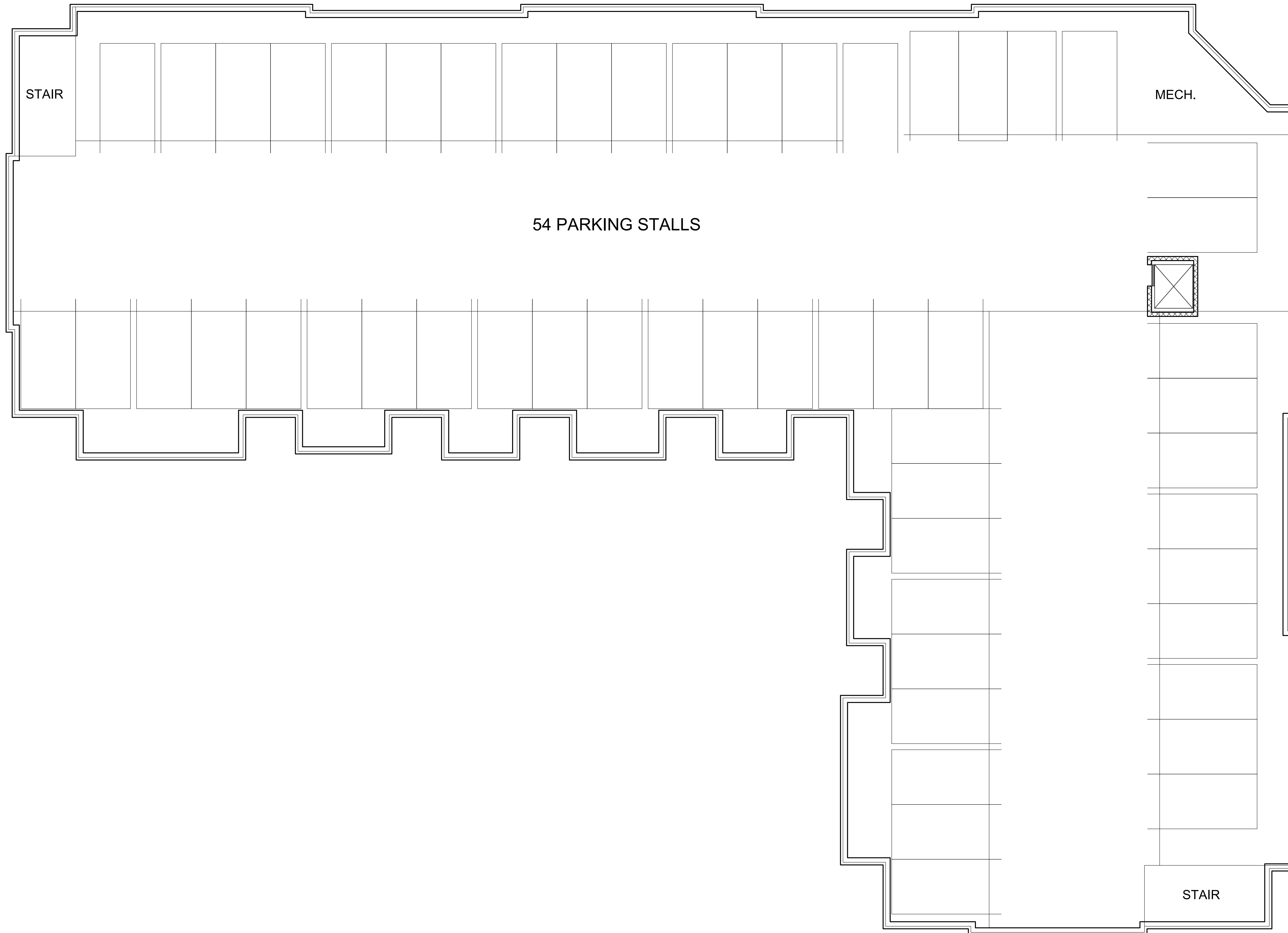

**1**  
**A100** BASEMENT FLOOR PLAN  
 1/8" = 1'-0"

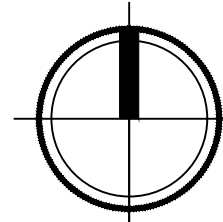

ISSUED

Issued for xyz - Month Day, Year

PROJECT TITLE

Pacific

Tiffin, Iowa

SHEET TITLE

First Floor Plan

SHEET NUMBER

**A101**

PROJECT NO.

2521

© Knothe & Bruce Architects, LLC



**1** FIRST FLOOR PLAN  
A101 1/8" = 1'-0"

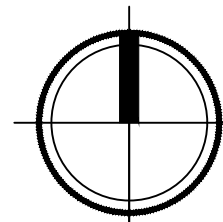



**knothe bruce**  
ARCHITECTS

Phone: 8401 Greenway Blvd., Suite 900  
608.836.3690 Middleton, WI 53562

ISSUED

Issued for xyz - Month Day, Year

PROJECT TITLE

Pacific

Tiffin, Iowa

SHEET TITLE

Second - Fourth  
Floor Plan

SHEET NUMBER

**A102**

PROJECT NO.

2521

© Knothe & Bruce Architects, LLC



**A102** SECOND - FOURTH FLOOR PLAN  
1/8" = 1'-0"

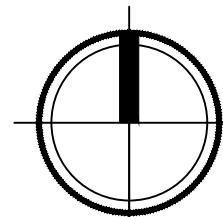



**knothe • bruce**  
ARCHITECTS

Phone: 8401 Greenway Blvd., Suite 900  
608.836.3690 Middleton, WI 53562



4 SOUTH ELEVATION  
A201 1/16" = 1'-0"



3 EAST ELEVATION  
A201 1/16" = 1'-0"



2 NORTH ELEVATION  
A201 1/16" = 1'-0"



1 WEST ELEVATION  
A201 1/16" = 1'-0"

ISSUED  
Issued for xyz - Month Day, Year

PROJECT TITLE  
Pacific

Tiffin, Iowa  
SHEET TITLE  
Exterior Elevations

SHEET NUMBER

A201

PROJECT NO. 2521

© Knothe & Bruce Architects, LLC